

Wireless Communication TW-800 series

TW-800 series are wireless products for Pokayoke tools using at production process

Cost down

Price down
Downsizing

Using Oversea

U.S.A/Canada/Thailand/
Malaysia/Indonesia/
Mexico...etc.
Getting a certification.

Diversification of use

Various kinds of tools
(Torque wrench/Plier
wrench and so on.)
Push button
Various kinds of sensor.

Improvement in reliability

2 Way Communication
Frequency Hopping
Function Original
Protocol

Correspondence to Network

Expand by serial port
LAN connecting
RS-232C connecting

Transmitter TW-800T

TW-800T is a transmitter used fixing to a torque wrench, plier wrench, check pen and so on.

- You can look see the communication OK/NG by LED lighting and flashing.
- TW-800T uses CR2032 type of battery. Battery life is about 300,000 shots.
- TW-800T has the function of remaining battery level notice and communication check by using test switch.
- It is used polypropylene material for protecting broken the case.

OPTION Protect Cover



For small size wrench [TW-510C-1]
For middle and big size wrench [TW-510C-2]

Ref) We recommend to use TW-510C-1 for small wrenches to the wrench not more than 50N.



Receiver TW-800R

TW-800R is a receiver of 1 point relay output type.

- TW-800R is used by AC100-240V by using AC/DC adaptor of an option.
- The diversity antenna which realizes stable communication is a standard.



- The diversity antenna which realizes stable communication is a standard.
- TW-800R is small and light. Weight is 250g, Dimension is 10cm x 8cm x 3cm.

Receiver with a extension unit of serial output TW-800R-EXS

TW-800R-EXS is a receiver having an interface of RS-232C.
TW-800R-EXS can receive signals from transmitters.
The number of transmitters does not have restriction.

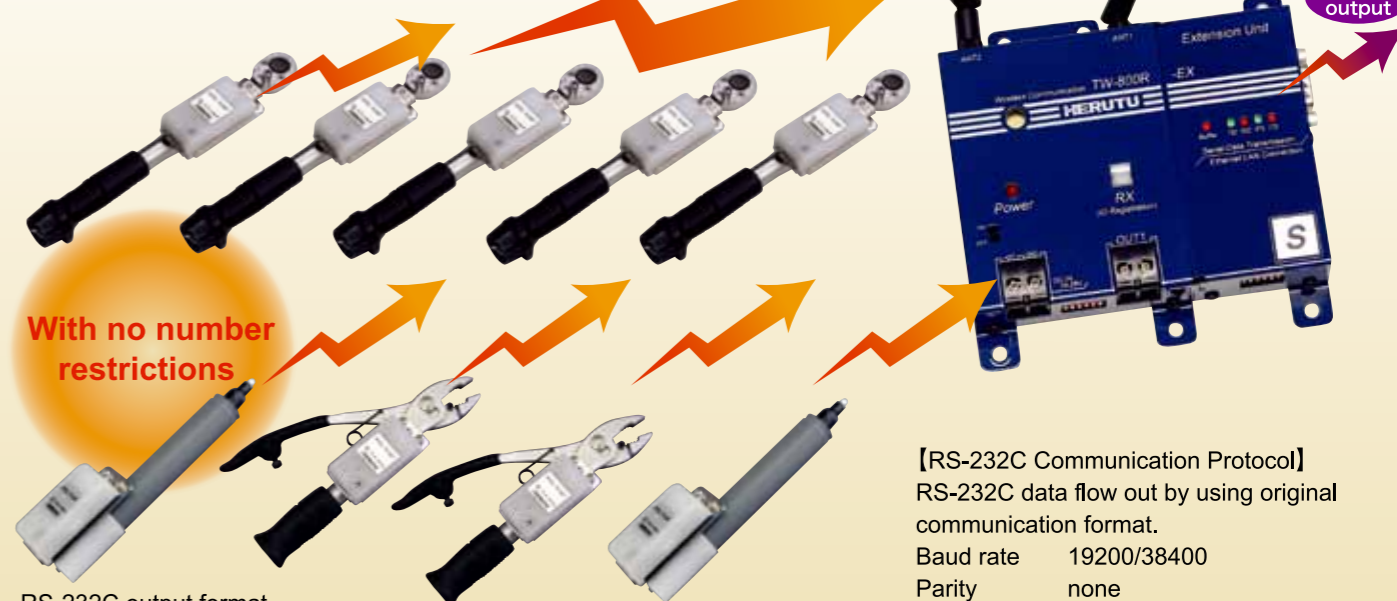

With no number restrictions

[RS-232C Communication Protocol]
RS-232C data flow out by using original communication format.
Baud rate 19200/38400
Parity none
Data length 8bit
Stop bit 1bit
Flow control RTS-CTS/none

RS-232C output format

| | | | | | |
|----------|-----|-----------------------|--|-----|-----------|
| Preamble | STX | Transmitter ID number | Tightening information Test SW, Battery information | ETX | Check sum |
|----------|-----|-----------------------|--|-----|-----------|

※We can make LAN type. Please contact us.

[Specification]

| Items | TW-800T | TW-800R | TW-800R-EXP | TW-800R-EXS |
|-----------------------------|---|---|---|---|
| Frequency | 2,403MHz~2,478MHz(An unassigned channel is automatically chosen by a frequency hopping function.) | | | |
| Communication | 2 way communication 250kbps | | | |
| Input | Limit switch 1point Test switch 1point | — | | |
| Output | — | Contact output* 4point Terminal block:M3(2P) Rated load voltage AC/DC30V per point Rated load current 0.5A per point | Contact output* 1point Terminal block:M3(2P) Rated load voltage AC/DC30V per point Rated load current 0.5A per point | Contact output* 1point Terminal block:M3(2P) Rated load voltage AC/DC30V per point Rated load current 0.5A per point |
| Interface | RS-232C×1 | | | |
| Display | LED 1 point(Red/Green) | LED for receiving(Green) * 1point (Combination lighting switch for pairing) Power LED(Red) * 1point | LED for receiving(Green) * 1point (Combination lighting switch for pairing) Power LED(Red) * 1point | LED for receiving(Green) * 1point (Combination lighting switch for pairing) Power LED(Red) * 1point Communication monitor LED * 5point |
| Buzzer | Electrical buzzer 95dB/m | | | |
| Power | Coin Battery(CR2032) | DC24V±20%(DC19~28V)(Terminal block:M3) | | |
| Consumption current | — | Under 60mA | Under 80mA | Under 90mA(At receiving standby under 50mA) |
| Operation temperature range | Temperature 0-50 degree Humidity Under 80% | | | |
| Dimension | 34W×71D×17.5Hmm (Except projection) | 80W×100D×28Hmm (Except projection) | 130W×100D×28Hmm (Except projection) | |
| Weight | Approx40g | Approx250g | Approx430g | Approx450g |
| Antenna | Dipole antenna(Diversity type) | | | |
| Battery life | Approx 300,000 shots (It changes with operating conditions.) | | | |

Receiver with a extension unit of 3 relay output TW-800R-EXP

TW-800R-EXP can receive signals from 4 transmitter by connecting an extension unit of 3 relay output. And TW-800R-EXP can output respectively.

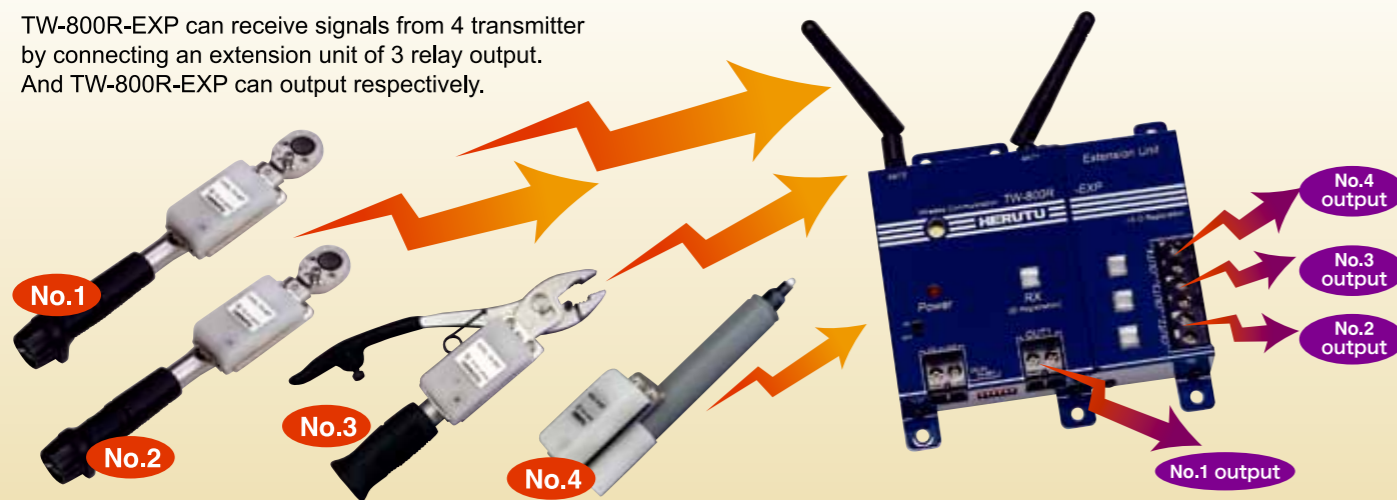

※We don't sell a body of torque wrench.

OPTION

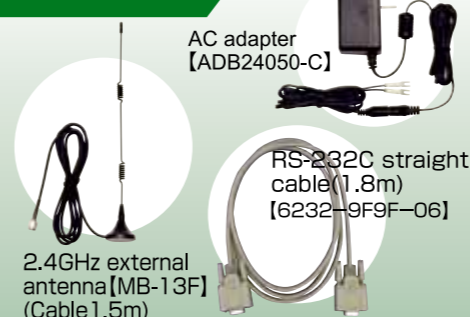

TW-510T/TWF-600
TWF-700R
Continuous sale

