

TW-800T-PLR Instruction Manual

This Instruction Manual only describes the points that differ from TW-800T.

Regarding other functions, see “TW-800 Instruction Manual”.

●Appearance

<TW-800T-PLR>

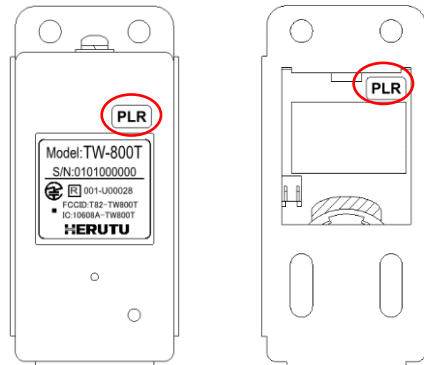

label 【PLR】 in the above two places.

●Timing of limit switch input and signal transmission

The TW-800T transmit a signal when the limit switch input is turned ON, but the TW-800T-PLR is designed to transmit a signal when the limit switch input is settled and turned OFF.

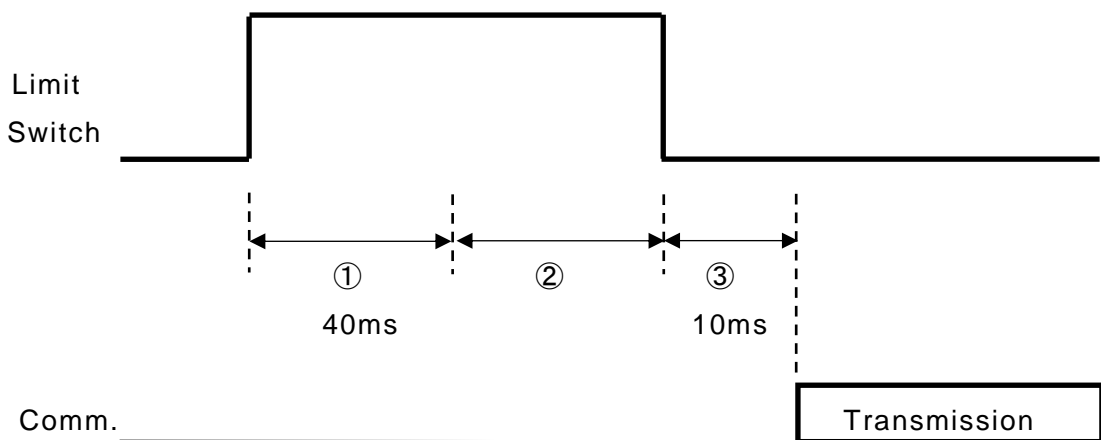

- ① The input is confirmed when the limit switch input is ON for about 40ms or more.
- ② Wait for the input to turn off once the input is fixed.
- ③ When the input OFF becomes about 10ms or more, OFF is confirmed and communication starts.

***Since the next limit switch input cannot be received during communication, it is necessary to wait more than the communication time (about 200ms).**

●Regarding battery life

Approx. 100,000 uses (depending on usage conditions)